

SYSTON MODEL RAILWAY SOCIETY

PRESENT THEIR

2024 MODEL RAILWAY EXHIBITION

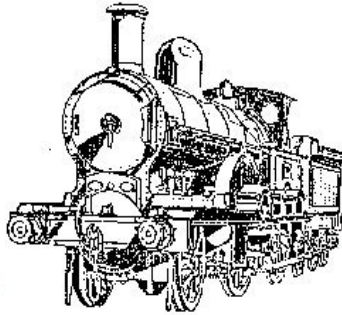

Welcome to this our Model Railway Exhibition. Our exhibition is now well established and we would like to thank everyone who has helped us get this far over the many years.

This includes **Roots @ Thorpe Farm** for their continuing support by allowing us to use their exhibition space, Other people and organisations who we are grateful to are our Tombola team, our exhibitors, our traders, **East Goscote Scouts** for the use of their tables and, of course, you the



BUGGLESKELLY STATION

Scale Models by Tom Marshall

VISIT US AT THE FOLLOWING SHOWS

- 1 June Sleaford, Lincs, NG34 7PP
- 2 June Northampton & Lamport Rwy
- 8 June Milton Keynes, Bucks, MK12 5TH
- 15 June Will Hay Day, GCR, LE12 8AG
- 22-23 June Nottingham THC, NG11 6NX
- 20-21 July Chatham Show, Kent, ME4 4TZ
- 17-18 Aug Loughborough, Leics, LE11 2AQ
- 28-29 Sept Stafford, Staffs, ST18 0BD



Buggleskelly Ltd. N Gauge

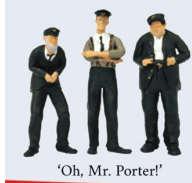
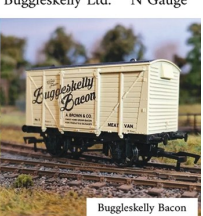
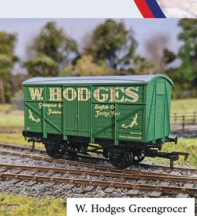
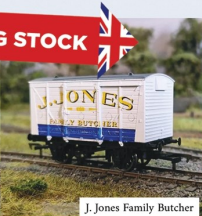
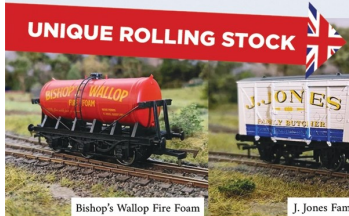

A CAST OF COMEDY CHARACTERS



BUILDINGS AND DIORAMAS FROM BUGGLESKELLY AND BEYOND

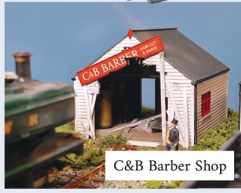

-  @BuggleskellyStation
-  @PhotograFixUK
-  @Buggleskelly
-  @ModelDioramas

www.buggleskellystation.com

PHOENIX JUNCTION

OO Gauge

Stand 1

The layout is set in the west midlands around the the Dudley area it represents a mainly goods lines that cris cross the old GWR and LNWR, the time is around the mid sixties it's cold and been snowing.

ST JOHNS

OO Gauge

Stand 2

St Johns is a South Devon branch line set in 1931 with Great Western steam locomotives hauling local and holiday passenger traffic, freight and milk trains along the fictitious line which is an imaginary extension of the Brixham branch line in the Torbay area. The layout is OO gauge and measures 16 feet by 2 foot 6 on 4 base boards 4 feet long and was built as a memory of my late father John who was born in 1931 hence the layouts name and year modelled . The locos are all ready to run models and feature DCC sound adding to the experience when viewing the layout which also has background sounds of the sea waves. There are many things to look for on the layout which has been built to capture the area and is not just about the trains. We hope you enjoy your visit to the seaside and welcome any questions you have.



UPTON WHENT

OO Gauge

Stand 3

Come and have a good look round our OO Gauge layout and enjoy the trains and scenery.

THE HOT TRACK

OO Gauge

Stand 4

The four mile long, two track railway known as "The Hot Metal Track" opened in 1979 to transport molten iron from the new Redcar Blast Furnace on Teesside directly to the BOC plant at the Lackenby Steelworks to become world renowned Teesside steel. The line was substantially constructed for the traffic was heavy and continuous; each wagon carrying 320 tonnes of molten iron in this around the clock operation.

This layout gives a small glimpse of some of the rail operations in a UK steel works. Most obviously there is the constant flow of molten iron from the blast furnaces to the steel plant using the iconic 'Torpedo' wagons. These travel on the Hot Metal Track which crosses the works entrance on a high level girder bridge proudly "Passionate About Steel". The yard behind sees internal user wagons and vehicles from the national network being moved around the works. Variety is the spice of life on an industrial railway and the colourful locomotive fleet includes ex-BR Class 20s, the former Norwegian Railways (NSB) Di8 Class imported specially for this line, Yorkshire Engine Company 'Janus' 0-6-0 diesel electric locos, the Scunthorpe Bo-Bo Hunslets and Port Talbot Brush Bagnall locomotives to name but a few. The Appleby Frodingham Railway Preservation Society operate brake van tours at the Scunthorpe Steelworks. I highly recommend you look them up and book your visit soon!



Model Railway
Information and
Resources

www.ukmodelshops.co.uk



CUMANAVAGO

OO Gauge

Stand 5

Cumanavago was conceived by Club member Jim Ross and Exhibited by him successfully until he was sadly struck by motor Neuron Disease. He became unable to attend exhibitions in 2020 and as the layout was popular the decision was taken to purchase it from him for the Club. Cumanavago is DCC controlled and is split into two halves, one for Children to Operate using a Hornby Select controller and the other is a shunting Puzzle for their parents to have a go at using an NCE Powercab controller. The children get a certificate for controlling Thomas and Percy in a set of several steps using a run round. The parents get the satisfaction of solving the shunting Puzzle. The below Questions are asked of the participants to encourage interaction with the public. 1 Can they spot the Wedding and identify how the wedding photographer is operated 2 Why is the policeman struggling to use the police box and why is it not box not a police box, and what TV show is it from. (clue is Doctor Who,s Tardis as it is located in a field) 3 Can they spot the running water.

**VICTORIA**

EM Gauge

Stand 6

Most medium to large stations used to have a couple of sidings 'out the back' for handling parcels traffic when such a thing existed! The layout imagines (with a slight twist to the actual location!) that these were the sidings for Victoria station in Central London. They handled all parcels and sundry traffic, but not newspaper traffic, which was taken elsewhere in the station. You will see the pilot loco shunting parcels stock in and out of the platforms to add to other trains and the occasional diverted passenger train.

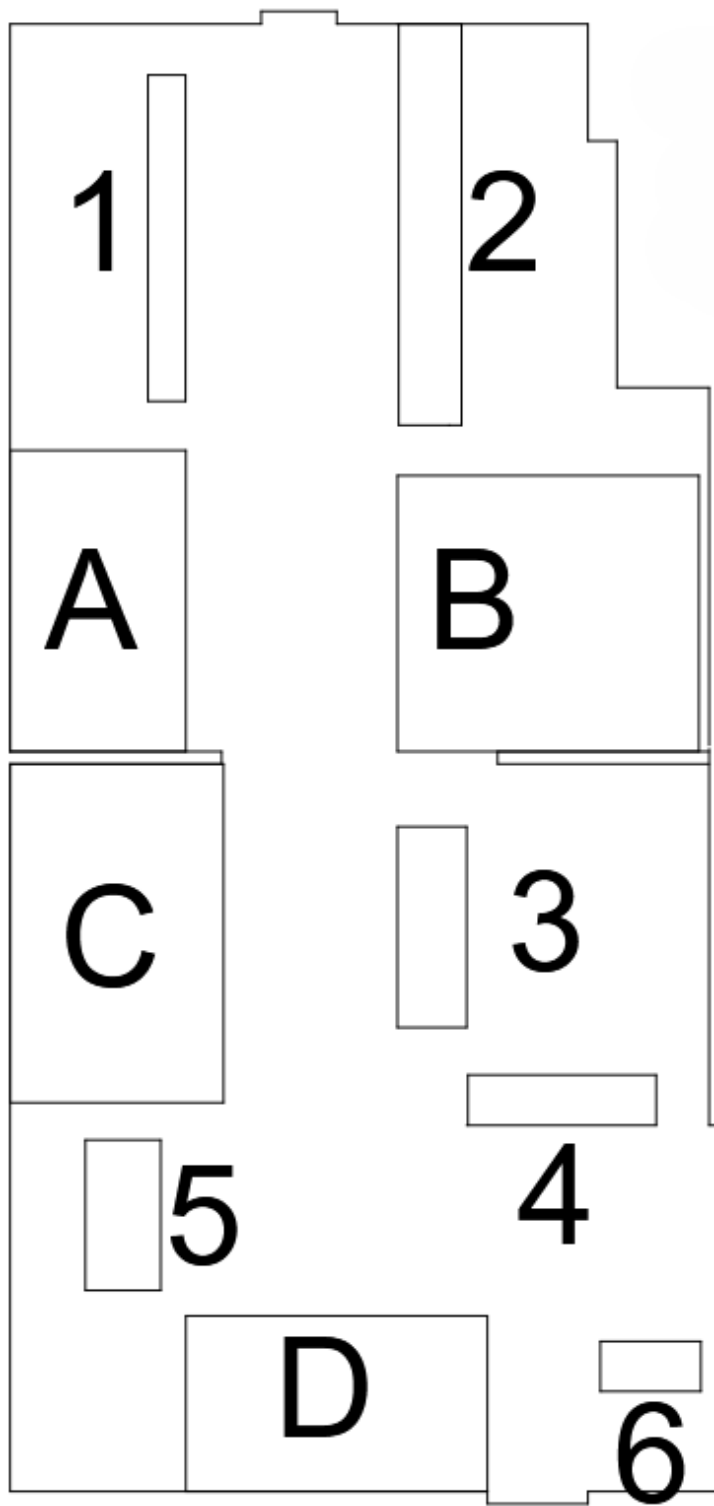

FLOOR PLAN

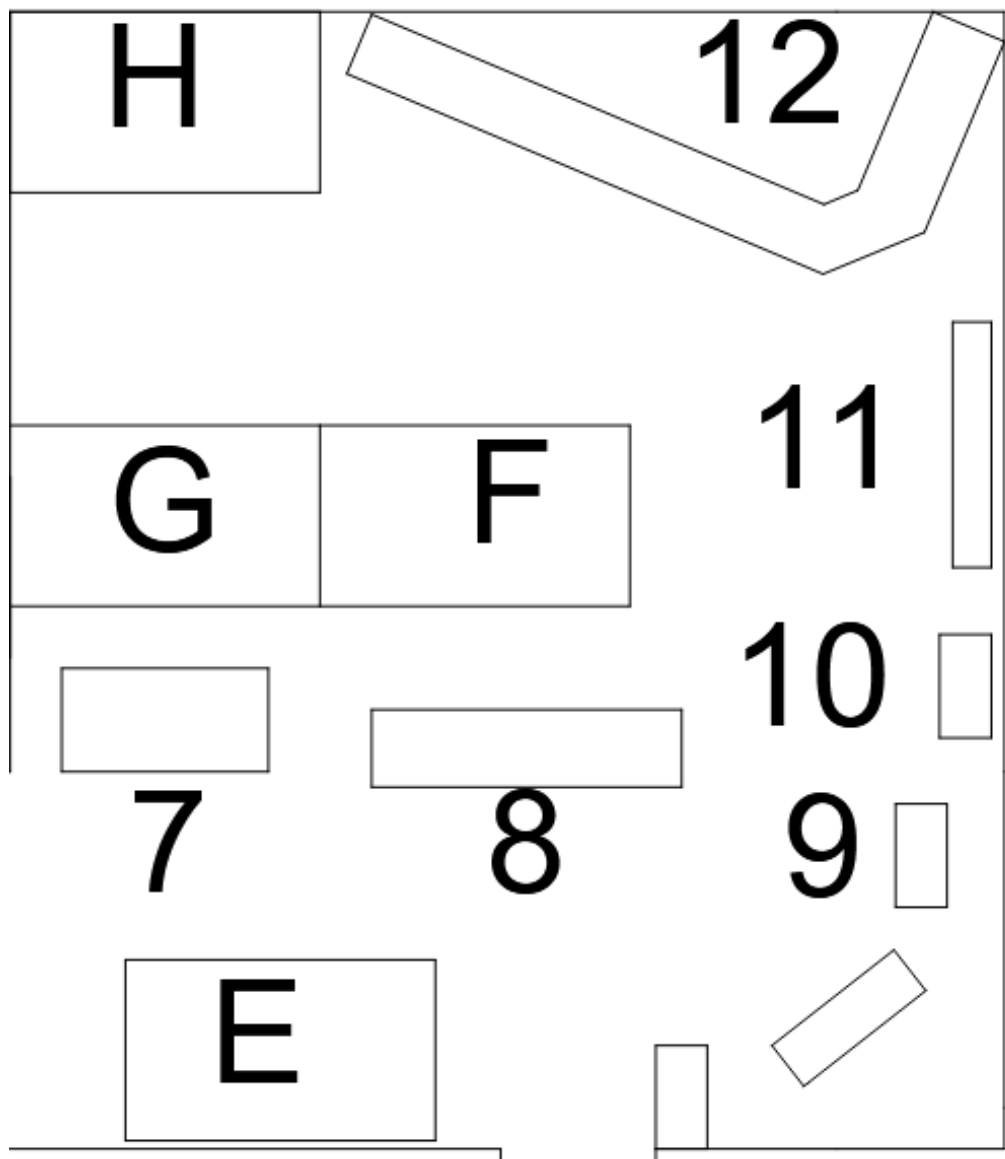

BREGSTADT

TT Gauge

Stand 7

Bregstadt is a fictional small town situated somewhere along a Black Forest valley somewhere East of Furtwangen and west of Vohrenbach. Up until 1976 there was a private railway, the Bregtalbahn, from Donaueschingen to Furtwangen. For the benefit of this layout the Bregtalbahn passed into new ownership in 1976 and survives on a hand-to-mouth basis with secondhand equipment and special steam trains run by the local Eisenbahnfreunde.

The layout is set in the late eighties, around the time of reunification. Short goods trains are hauled by a variety of secondhand diesel locos, with a passenger service provided by 4-wheeled railbuses bought from the DB, and steam specials. Traffic to the yard at Bregstadt is shunted by diesel shunters including an 08 bought cheaply from British rail.



Layout pictured with about 6 months of building still to go.

NORTH ROAD

N Gauge

Stand 8

North Road, no relation to Darlington. A twin track DCC layout incorporating a repair & fuel depot, carriage and wagon repair facilities. Totally fictitious, can be located anywhere you choose. All tracks are code 55 finescale Peco nickel silver streamline with unifrog points. Set in a busy market town in a low-level position providing all manner of running and shunting possibilities. 55+ Metcalfe kits, some detailed with guttering and down pipes, low relief and full size to create the town effect on the upper level where Faller 'N' gauge vehicles can be seen running.

Railway buildings are a mixture of Peco Manyways kits, Graham Farish and Hornby Lyddle End. The bridge is scratch built using various Peco girder bridge sides and trestle kits. Modern street and yard lighting, including strip led's, the pedestrian crossings and operating traffic lights and colour light signals / modules are all supplied by Layouts4U, CR Signals and ModelEx..

WILLEVIE

OO9 Gauge

Stand 9

Small oval two track layout with engine shed, siding and passenger halt.

BOTTOM OF THE BARREL

OO Gauge

Stand 10

Burton on Trent was famous for two things Beer and Railways, at its peak there were over 30 Breweries in the town. Many brewers from across the country built their breweries here to access the waters of the Trent, at this point the gypsum content in the water allows for successful use of a greater amounts of hops. Hops, as well as flavoring beer, are a natural preservative, allowing beer to travel further, meaning beers from burton could survive the long journey across the British Empire to places as far as India.

This Model shows the Trent Brewery, which was built by Thomas Sykes in 1881, its 50 employees could produce around 20,000 barrels annually. In 1893, the brewery was re-named the Trent Brewery. This OO Gauge Model shows the whole brewing operation from around 1950, from the malt intake to the cask racking and bottle Line, along with the daily movements of wagons across the brewery railway system.

EYEMOUTH

N Gauge

Stand 11

This working model depicts the station area as it was in the years after WWII. The project was begun during the lockdown period in March 2020 and took almost a year to complete, each element taking many hours to create, inspiration stemming from an article in Steam Days magazine (Feb. '99). I had read this some years before and had thought that it would make an interesting project at some point. The confinement that came about in spring 2020 was the ideal opportunity to begin to turn it into a reality. The railway facilities provided at the station being fairly simple, just an entry road with run-round loop and two sidings, it was the handsome row of houses along Victoria Road that was the main attraction for me. In addition, the land levels from the river to the houses provide another interesting dimension. The buildings were all "scratch built", that is individually crafted from plain plastic sheet, laminated with stone, brick or tile sheets in the same material. Dimensions were gained by using a measurement tool on a mapping website. Traffic was limited to a return passenger service from Burnmouth, on the main line north of Berwick-upon-Tweed, freight being largely concerned with the fishing industry. The line closed in 1962 and there is little trace of it left.

GLENMORE PARVA

OO Gauge

Stand 12

It is a fictional location and with no allegiance to any particular region or company and a time around the change from steam to diesel operation. This is to suit members' stock and interests and is an end to end layout which is double tracked into a ten lane fiddle yard.

This gives the opportunity to have passing trains, not always seen on an end to end layout. The terminus station "Glenmore Parva" has two main platforms with a central loco release line and a bay platform for local service to "Shepshed".

The station also has a small goods yard and private line to local industry area, which runs down under the main lines to the rear of the layout. There is an operational turntable to enable locos to be turned and make the return journey from the station to the fiddle yard. It planned to run to a timetable to get consistent movements on the layout for the interest of the operators and viewing public. It also has operating station and buffer lamps and an increasing number of operational signals and other features being added.

TRADERS

Sherwood Models

Stand A

J & C Model Railways

Stand B

Starlight Models

Stand C

Baz Model Rail

Stand D

Booklaw

Stand E

Brickyard Models

Stand F

See our advert on page 11

Buggleskelly Station

Stand G

See our advert on page 2

Barwell Airbrush

Stand H

Club Sales

COME AND JOIN US

We are welcoming new members to the club now that we are in new clubrooms that allow us to have our layouts erected as well as workstations and a library. The club models in N, OO & OO9 in a variety of eras. We welcome modellers of different abilities and interests and happy to help you develop your skills and knowledge.

Ask for an introduction form at the Club Sales Stand or Ticket Desk so that we can be in touch with you.

Tombola

The tombola is outside (weather dependant) and you have a chance to win a variety of items. Every single penny spend at the tombola goes to charity. Each year, the club picks a member to select a charity. The member picked this year has chosen Hope Against Charity. The reason for this is that member is fighting cancer and that charity's work has allowed them to have some new treatment that is hoped will make a difference to them.



Best Layout and Prize Draw

Remember to vote for your favourite layout, as that layout is awarded a trophy and at most shows the exhibitors try to win the Best Layout accolade. In addition to this, you have a chance to win an online voucher of £25 to spend at Macs Models.

On this form, there is a few questions to allow is to understand a bit more about our visitors and you can also leave some information to receive advanced information about next years show with the added incentive to get 2 free full price tickets for next years show.

If you need an additional form, then ask at the Club Sales Stand or Ticket Desk

SAVE THE DATE

Next years show has a provisional date

Sat 17th May 2025 &

Sun 18th May 2025

Scan the QR to visit our
website or visit

www.systonmrs.org.uk



11

BRICKYARD MODELS

**MODEL RAILWAYS BOUGHT AND
SOLD**

- **RESPRAYS AND RENUMBERING,
LOCOS, COACHES, WAGONS**
- **WEATHERING**
- **REPAIRS AND SPARES**

**WE ALSO STOCK A WIDE RANGE OF
TRACTORS & FARM IMPLEMENTS**

Tel : 01636 689963

Mobile : 07967 956683

**Email :
roger.garrett2@virginmedia.com**

MAC'S MODELS



**Precise 3D Printed Model Railway
Products at an Affordable Price**



WWW.MACSMODELS.ONLINE



macsmodelsonline



macsmodelsuk



SCAN ME